TECHNICAL MANUAL

MCC-2

Effective from 01.01.97.



P.O. Box 54/ Hvamsvingen 11
N-2013 Skjetten, Norway

Phone: +47.63 84 39 10
Fax: +47.63 84 54 18

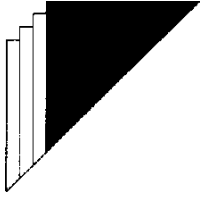

MCC-2

TABLE OF CONTENTS

1. General information.	1 - 1
1.1 Normal use of MCC-3 system.	1 - 1
1.2 Handling.	1 - 1
1.3 Training..	1 - 1
2. Technical data.	2 - 1
3. Installation.	3 - 1
3.1 Standard pneumatic connections.	3 - 1
3.2 Pneumatic connections with remote control.	3 - 3
4. Operation.	4 - 1
4.1 Getting started.	4 - 1
5. Maintenance.	5 - 1
5.1 Service.	5 - 1
6. Spare parts.	6 - 1
7. Diagrams.	7 - 1

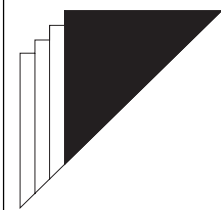

MCC-2

GENERAL INFORMATION

1. General information.

This system is supplied by:

GP-Tinter A.S
P.O. Box 54
N-2013 Skjetten
Norway
Phone: +47 63 84 39 10
Telefax: +47 63 84 54 18

1.1 Normal use of MCC-2 system.

The Manual Colour Change System MCC-2 is designed to work as a supply system of ink to GP-Tinters. The system is designed to handle mainly alcohol based inks, in addition also waterbased and UV-based inks, in viscosities up to 30 sec. in Zahn Cup 2.

1.2 Handling.

The MCC-2 system should not be exposed to shock, high humidity or temperatures above 50° C during transportation, installation and use.

1.3 Training.

Contact the local agent or GP-Tinter for training.

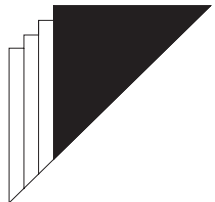

MCC-2

TECHNICAL DATA

2. Technical data.

Air pressure: 6 bar / 85 psi.
Air consumption: 500 l/m.
Number of ink tanks: 5, each approx. 40 liter.
On/Off solenoid: 220 volt AC std. Other voltages can be delivered on request.
Pump: With air motor.
Air Supply: To operate the MCC-2 system together with the tinter.
Recommended oil: SAE 30.
Weight: 37,5 kg.
Dimensions: See Fig. 2.A and 2.B..

Optional Equipment: Remote Control Unit.

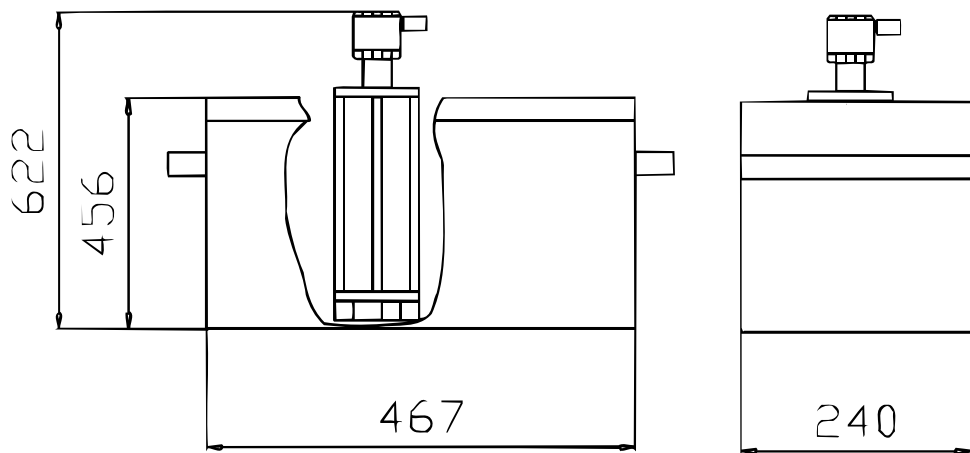

Fig. 2.A.

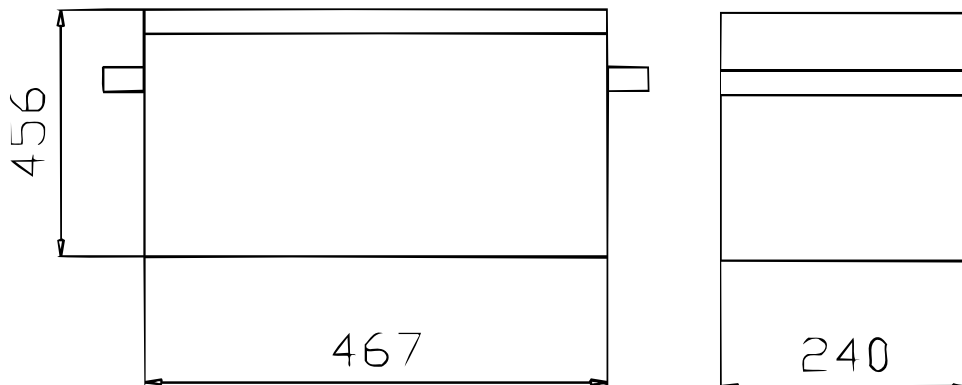

Fig. 2.B.
Additional tank.

MCC-2

INSTALLATION

3. Installation.

1. Place the tanks close to the GP-Tinter and connect the ink hoses between the Tinter, Pump and the Pump tank lid.

NOTE! Make sure that there is an even fall on the hoses between the Tinter and the PMU so that no ink will be trapped after the ink or cleaning solvent is drained.

2. Connect the solenoid inside the Solenoid Box (OR REMOTE CONTROL UNIT) to a start/stop signal from the press.

This signal will start and stop the tinter automatically with the press.

NOTE! Make sure that the signal from the press is ON only during normal production, NOT while jogging the press.
Normal voltage is 220 volt AC. Other voltages can be delivered on request.

3. If Remote Control Unit.

Mount the Remote control unit near the main control panel on the press.

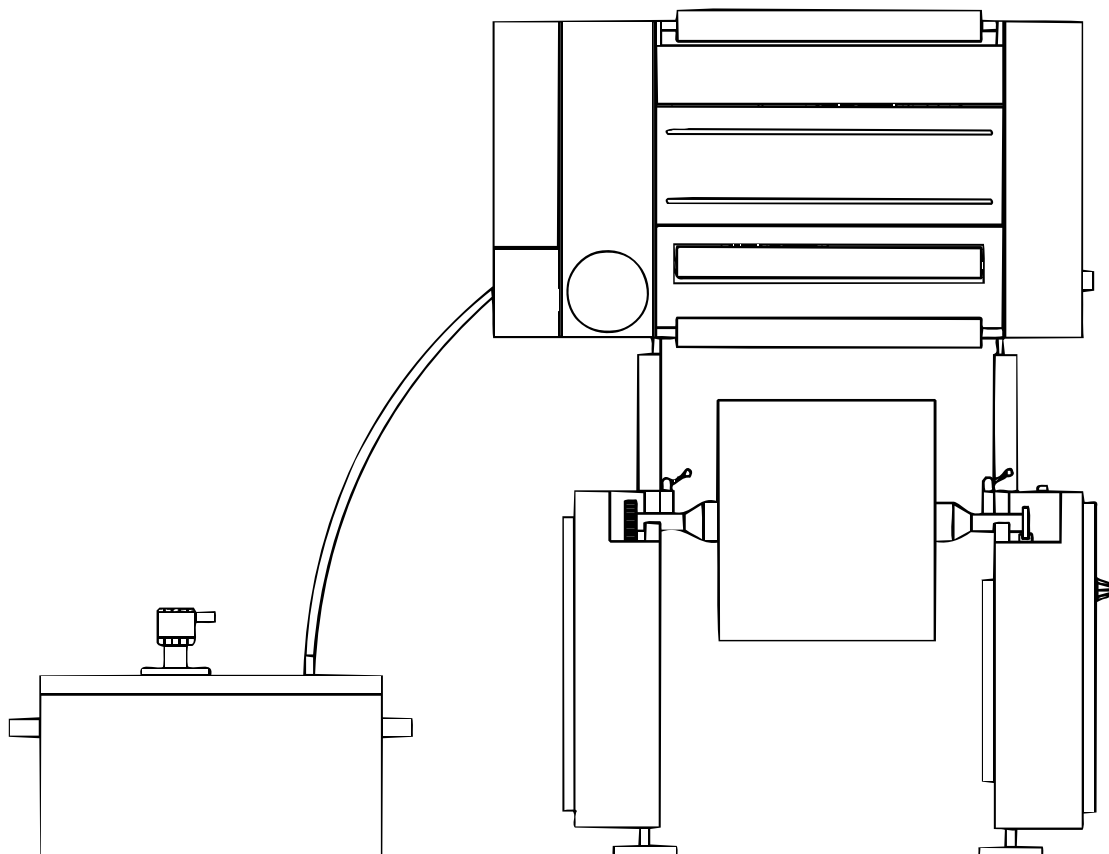

Fig. 3.1
MCC-3 installation.

MCC-2 INSTALLATION

3.1 Standard pneumatic connections.

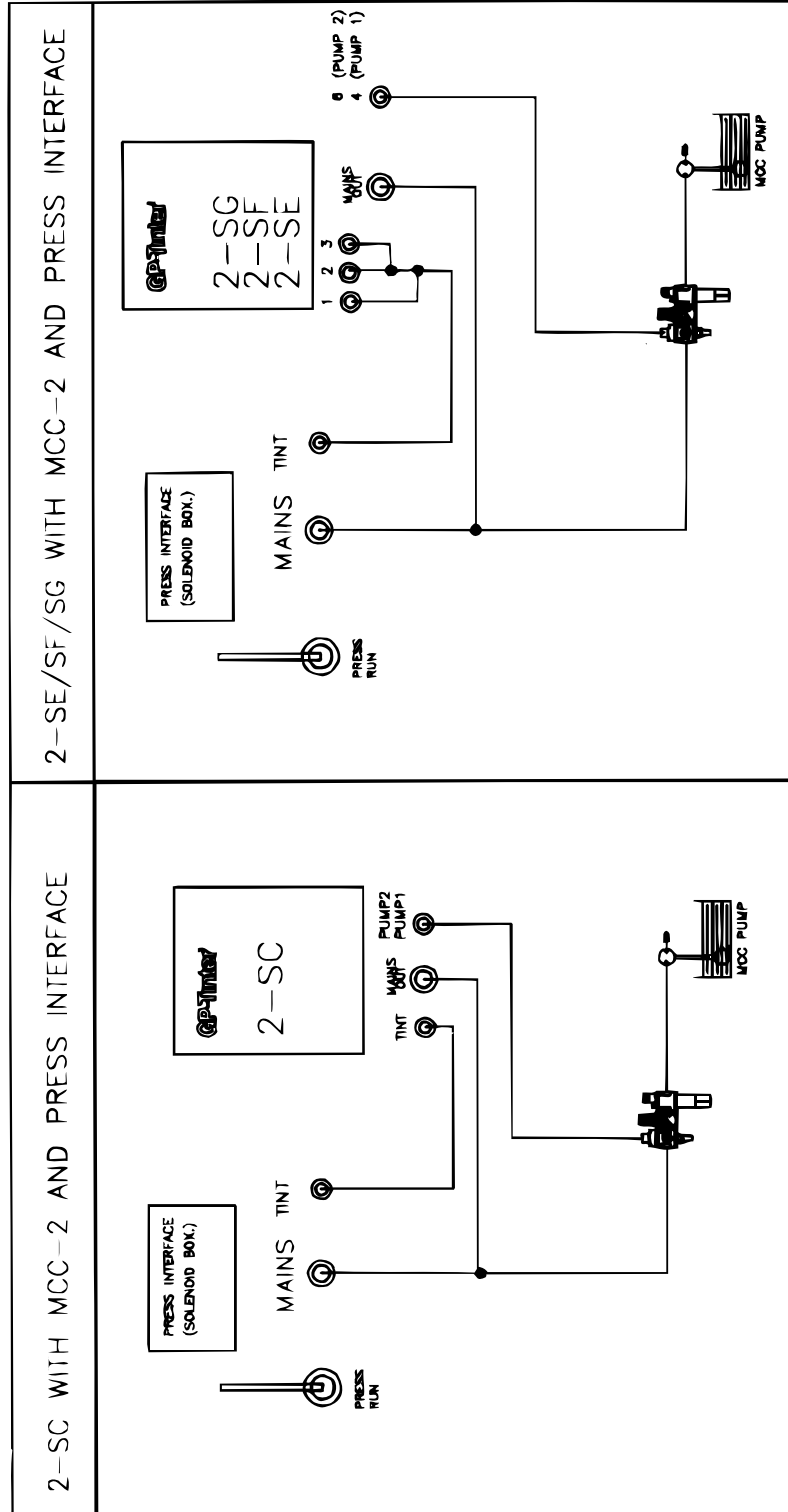

Fig. 3.2
Standard pneumatic connections.

MCC-2

OPERATION

4. Operation.

4.1 Getting started.

The start and stop of the MCC-3 system can be operated from the Main Control Panel on the tinter, or from a remote control (Optional) if it is installed.

- Mount the pump to the pump tank lid.
- Mount the flow regulator on the inlet hose of the tinter.
- Mount the air supply in a suitable position.
- Connect the pneumatic tubes, see the following page.
- Remote control unit.
- Place the tank lid with the pump on the desired tank (Colour).
- Start the pump from the main control panel or remote control.
- Adjust the regulator on the air supply so overflow can be avoided.
- Stop the pump.

The liquid will drain from the tinter and back to the tank. When there is no liquid left in the tinter hose, the system is ready for new colour.

NOTE! The MCC-2 system has no wash-up functions. To prevent the ink from drying inside the pump and system, we recommend that one of the tanks should be dedicated as a cleaning tank that contain clean and proper cleaning solution.

1. Adjustable air pressure

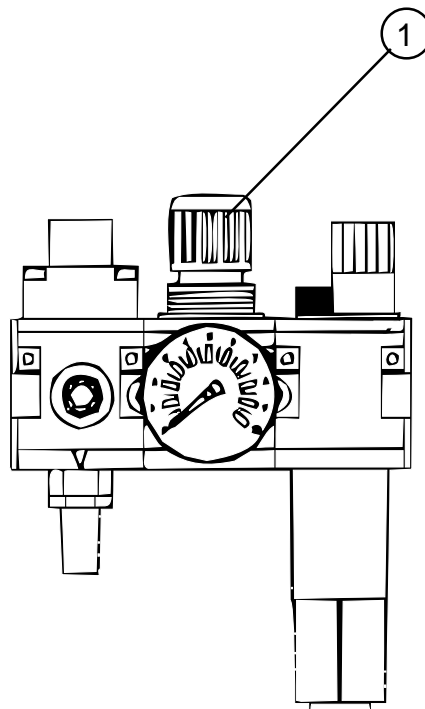
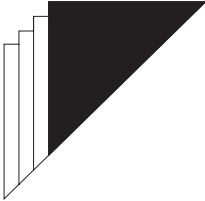

Fig. 4.1



MCC-2

MAINTENANCE

5. Maintenance.

Description	Daily	Weekly	Monthly
Mix. the ink in the tanks. (In some inks, the pigments fall to the bottom during time.)	X		
Inspect the pump and clean it if necessary.			X
Run Extra Wash-UP.		X	

5.1 Service

Service can be arranged by contacting your local agent.

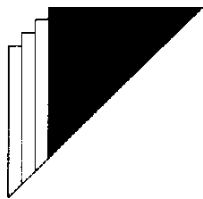

MCC-2

SPARE PARTS

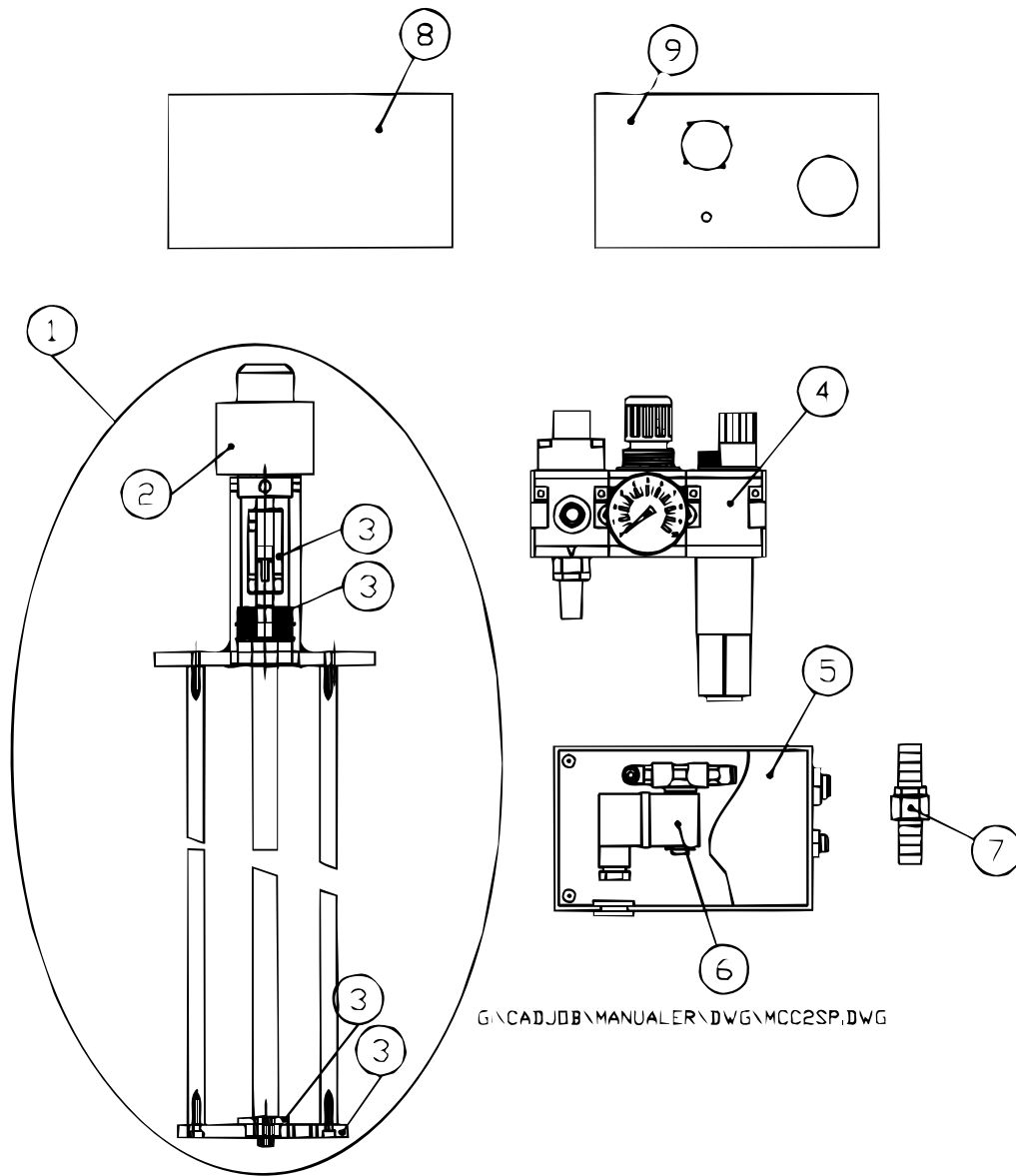

Pos. No.	Art.no.	Description	Pos. No.	Art.no.	Description
1	8209.00100	MCC Pump, Long.	7	5200.00800	Flow Restrictor MCC Pump
2	3100.07700	Air motor.	8	9209.00300	St.Steel tank MCC c/w std lid
3	8209.03000	Repair kit MCC Pump Long.	9	9209.00400	St.Steel tank MCC c/w Pump lid
4	8509.00500	Air Supply.			
5	8209.00700	Solenoid Box Tinter.			
6	Coils				
	3109.04500	12v DC			
	3100.15500	24v DC			
	3109.09100	48v DC			
	3100.15200	240v AC			
	3100.15300	110v AC			
	3100.15400	24v AC			